

1.0 PERFORMANCE:

- 1.1 FREQUENCY RANGE DC-26 GHz
- 1.2 VSWR TYPICAL
  - < 1.10 DC - 12.4 GHz
  - < 1.20 12.4 - 18 GHz
  - < 1.31 18 - 26 GHz
- 1.3 SYSTEM IMPEDANCE 50 OHMS
- 1.4 DWV: 750 Vrms @ 60 Hz (SEA LEVEL)
- 1.5 VOLTAGE RATING: 250 VRMS (SEA LEVEL)
- 1.6 TEMP RANGE: -65 / +165 °C

2.0 MATERIALS

- 2.1 CONTACT: BeCu
- 2.2 LOCKING RING: BeCu
- 2.3 COUPLING NUT: STAINLESS STEEL
- 2.4 CRIMP FERRULE: SOFT COPPER
- 2.5 BODY: BRASS
- 2.6 INSULATOR: PTFE
- 2.7 GASKET: SILICONE RUBBER
- 3.0 FINISHES: SEE TABLE

4.0 MECHANICAL

- 4.1 INTERFACES PER MIL-STD-348
- 4.2 COUPLING PROOF TORQUE 15 INCH\*LBS
- 4.3 COUPLING NUT RETENTION 60 LBS AXIAL
- 4.4 CONTACT RETENTION 6 LBS AXIAL
- 4.5 DURABILITY: 100 CYCLES

DWG NO. OL-1201-28-1			REV. E
PART NUMBER 1201-28-GJP	BODY GOLD	CONTACT GOLD/Ni	CPL. NUT PASSIVATE

PLATING PER SAN-TRON SPEC. 7.3.1-8

.010 CONTACT:BODY &  
.000 INSULATOR:BODY

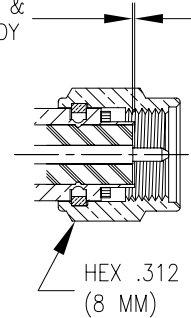

CRIMP HEX SIZE: .213

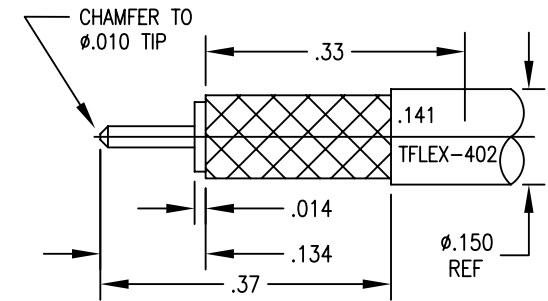
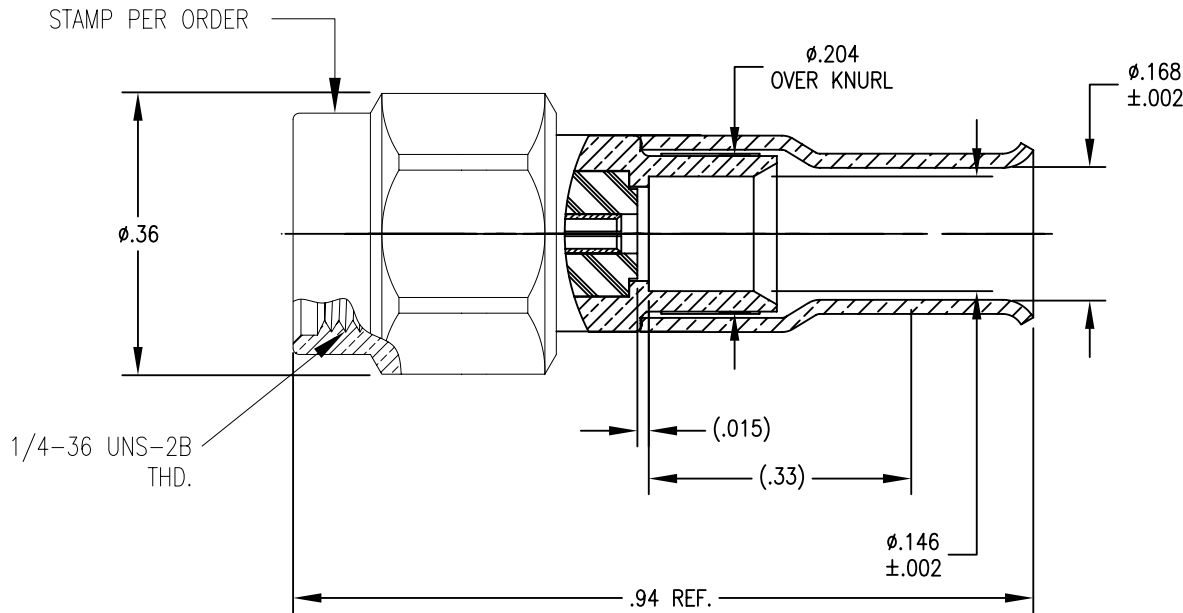

ASSEMBLY INSTRUCTIONS:

- 1) WINDOW STRIP JACKET AT 0.10 THRU 0.37
- 2) PRE-TIN THE BRAID USING MINIMUM SOLDER
- 3) STRIP BRAID AT 0.134
- 4) STIP CENTER CONDUCTOR LEAVING .014 DIELECTRIC
- 5) POINT CENTER CONDUCTOR
- 6) FIXTURE SMA INTERFACE
- 7) INSERT CABLE FULLY INTO CONNECTOR BODY
- 8) APPLY HEAT TO CONNECTOR BODY ONLY AND SOLDER BRAID
- 9) LIMIT SOLDER WICKING TO 0.33
- 10) SLIDE ITEM 43 INTO PLACE AND CRIMP

DO NOT SCALE DRAWING

Rev.	Revisions	Disp.	Date	Dwn.	Appd.
E	RELEASE FOR PRODUCTION	NEW	8/4/06	FSH	FSH
D	OPTIMIZATION EXPERIMENTS	NEW	3/10/06	FSH	PEND
C	OPTIMIZATION EXPERIMENTS	NEW	3/10/06	FSH	PEND
B	.12 WAS .10, REMOVE .030 EXPOSED CORE ON CABLE CUTBACK PICTORIALLY UPDATE TO REFLECT INSULATOR MODIFICATION		3/17/06	DVP	FSH
A	ORIGINAL	NEW	1/3/05		
RECOM.	STOCK SIZE	FT/M	PCS	Ref.:	SK
REMOVE ALL BURRS AND SHARP EDGES .005 MAX.		INTERPRET PER ASME Y14.5M-1994			

THIS DRAWING CONTAINS CONFIDENTIAL INFORMATION PROPRIETARY TO SAN-TRON INC. IT MUST NOT BE REPRODUCED OR DISCLOSED TO OTHERS OR USED IN ANY OTHER WAY, IN WHOLE OR PART EXCEPT AS AUTHORIZED IN WRITING BY SAN-TRON INCORPORATED.

UNLESS OTHERWISE SPECIFIED:  
ALL DIMENSIONS ARE IN INCHES.  
ALL DIMENSIONS ARE AFTER PLATING.  
.XXX = ±.005 ALL MACHINED SURFACES <sup>63</sup>/ MAX.  
.XX = ±.01 ANG. ±1/2° FRACTIONAL = ±1/64

Ⓞ.004 MAX. TIR      ⊥ AXIS .001

THIRD ANGLE PROJECTION

DWN	LAP	1/3/05
CHKD	SJS	X
APPR	FSH	1/3/05

**SAN-TRON, INC.**  
4 NEWBURYPORT TPK. IPSWICH MA USA 01938  
TEL: 978 - 356 -1585 FAX: 978 - 356 -1573  
WWW.santron.com E MAIL: santron@santron.com

TITLE: eSMA PLUG, STRAIGHT, EZ STYLE, T-FLEX 402, SS-402 (Ø.141)

MATERIAL: SEE NOTE 2.0	FINISH: SEE NOTE 3.0
CAGE CODE: 50896	DWG NO. OL-1201-28-1
SCALE: 4:1	REV. E